

CRYSTAL SYMPHONY | DECK PLANS

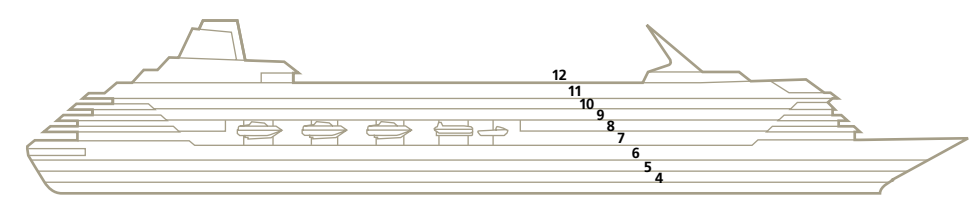

- Sun Deck 12
- Lido Deck 11
- Penthouse Deck 10
- Seabreeze Deck 9
- Horizon Deck 8
- Promenade Deck 7
- Tiffany Deck 6
- Crystal Deck 5
- Excursion Deck 4

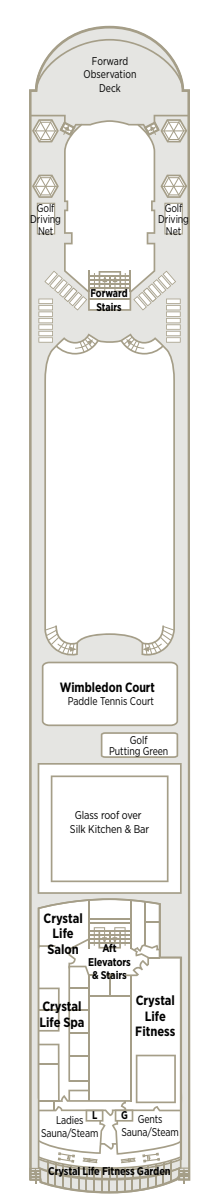

- SUN DECK 12**
- Crystal Life Fitness
 - Crystal Life Fitness Garden
 - Crystal Life Salon
 - Crystal Life Spa
 - Golf Driving Nets
 - Golf Putting Green
 - Observation Deck
 - Sun Deck
 - Wimbledon Court

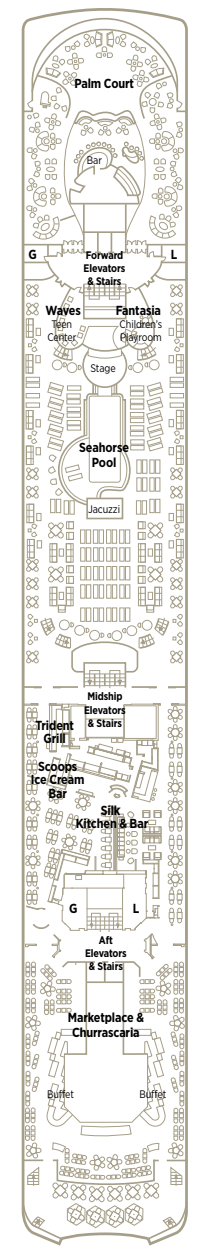

- LIDO DECK 11**
- Fantasia
 - Marketplace & Churrascaria
 - Palm Court
 - Scoops Ice Cream Bar
 - Seahorse Pool/Jacuzzi
 - Silk Kitchen & Bar
 - Trident Grill
 - Waves

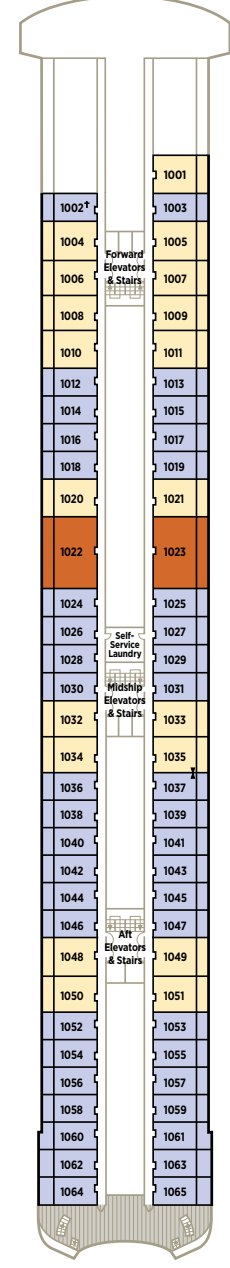

PENTHOUSE DECK 10

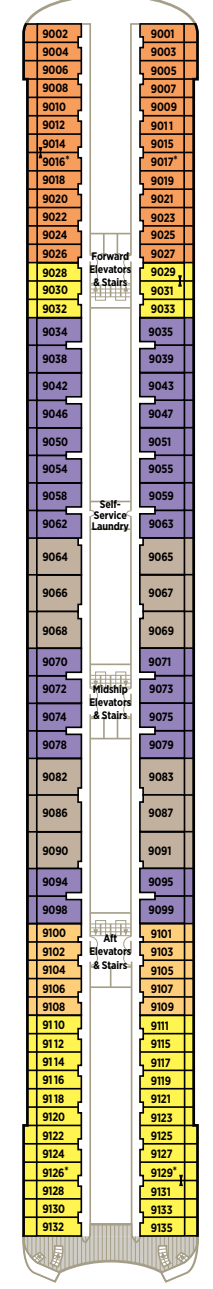

SEABREEZE DECK 9

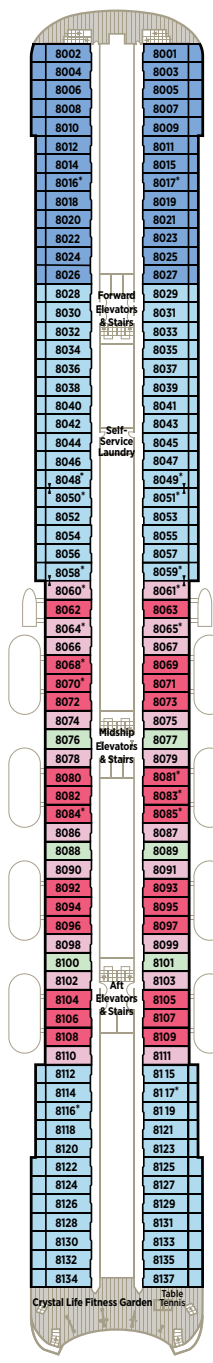

HORIZON DECK 8

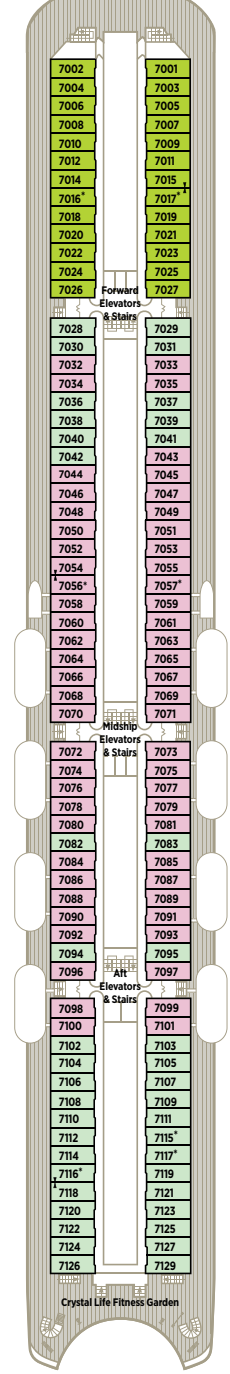

PROMENADE DECK 7

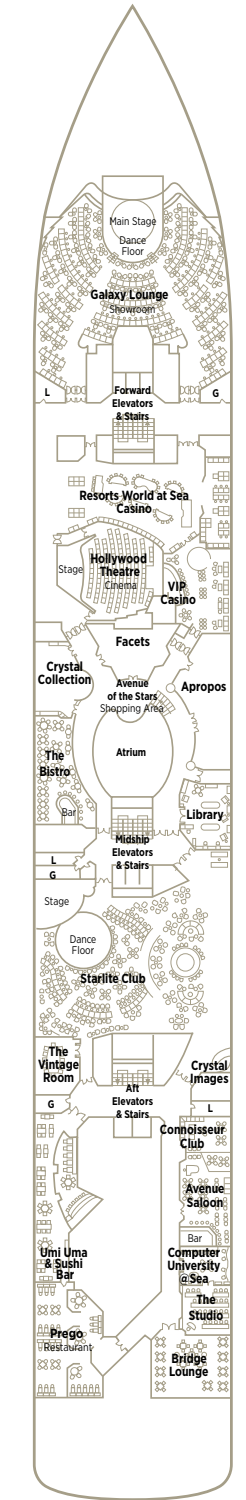

TIFFANY DECK 6

- Apropos
- Atrium
- Avenue Saloon
- Bridge Lounge
- Crystal Collection
- Crystal Images
- Computer University@Sea
- Connoisseur Club
- Facets
- Galaxy Lounge
- Hollywood Theatre
- Library
- Prego
- Resorts World at Sea Casino
- Starlite Club
- The Bistro
- The Studio
- The Vintage Room
- Umi Uma & Sushi Bar
- VIP Casino

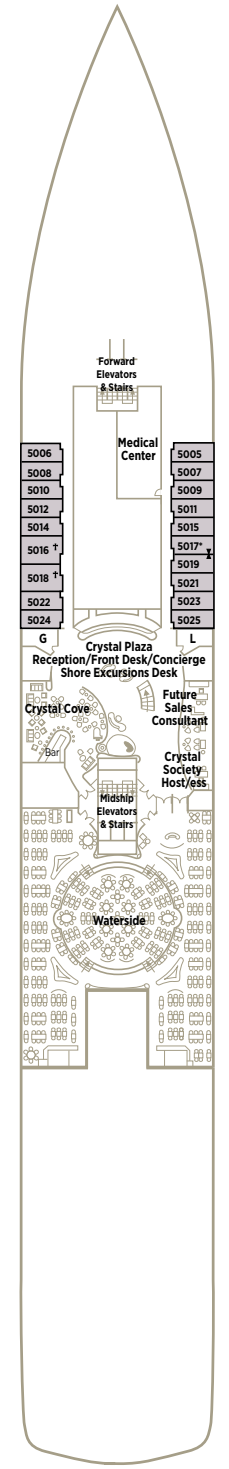

CRYSTAL DECK 5

- Crystal Cove
- Crystal Plaza
- Crystal Society Host/ess
- Future Sales Consultant
- Medical Center
- Waterside

SUITE / STATEROOM CATEGORIES

- CRYSTAL PENTHOUSE WITH VERANDAH (CP) | 982 SQ. FT. (91.2 SQ. M.)
- PENTHOUSE SUITE WITH VERANDAH AND THIRD BERTH (PS) | 491 SQ. FT. (45.6 SQ. M.)
- PENTHOUSE WITH VERANDAH AND THIRD BERTH (PH) | 367 SQ. FT. (34 SQ. M.)
- SEABREEZE PENTHOUSE SUITE WITH VERANDAH AND THIRD BERTH (SP) | 491 SQ. FT. (45.6 SQ. M.)
- SEABREEZE PENTHOUSE WITH VERANDAH AND THIRD BERTH (SH) | 367 SQ. FT. (34 SQ. M.)
- DELUXE STATEROOM WITH VERANDAH A1 | A2 | A3 | B1 | B2 246 SQ. FT. (23 SQ. M.)
- DELUXE STATEROOM WITH LARGE WINDOW C1 | C2 | D | 202 SQ. FT. (18.7 SQ. M.)
- DELUXE STATEROOM WITH LARGE PICTURE WINDOW E1 | E2 | 202 SQ. FT. (18.7 SQ. M.)

SPECIFICATIONS

- GUEST CAPACITY 848
- PER GUEST STAFF RATIO67
- GROSS REGISTERED TONS 51,044
- LENGTH 781 FT. (238.1 M.)
- WIDTH 99.1 FT. (30.2 M.)
- DRAFT 24.9 FT. (7.6 M.)
- CRUISING SPEED MAX 20 KNOTS
- TOTAL CREW 566

* Third berth available; as well as in all Penthouses (CP, PS, PH, SP and SH) with the exception of 1002, designed for guests with disabilities. Note: Third berth waiver is required. See CrystalCruises.com for details.

† Staterooms for guests with disabilities

▶ Connecting staterooms

CRYSTAL SYMPHONY | SUITE / STATEROOM DESCRIPTIONS

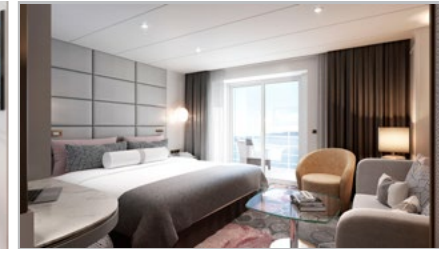

CRYSTAL PENTHOUSE WITH BUTLER SERVICE 982 SQ. FT. (91.2 SQ. M.) WITH VERANDAH

- CP
- › Private verandah with teak furniture
- › Spacious living room with custom wool carpets, walnut floors, cabinetry and Swarovski chandelier
- › Dining area with panoramic ocean views
- › Custom entertainment center with 55" OLED TV and Bose surround sound
- › Separate study
- › Custom built-in bar
- › Large bedroom with queen-size bed or twins beds with Frette linens, plus his and her walk-in closets and 32" ultra-thin interactive HD TV
- › Master bath with Jacuzzi, ocean view, crystal sconces and Calacatta marble floors, aquavision television, separate shower and bidet
- › Guest bathroom
- › Complimentary welcome bottle of champagne upon arrival
- › Complimentary wine plus choice of spirits from set menu upon embarkation
- › Complimentary newspaper of your choice once daily
- › Binoculars
- › Free in-suite phone usage (two hours per cruise)
- › Free pressing, laundry and dry cleaning
- › Unlimited complimentary specialty restaurant dining (by reservation, based on space availability)
- › "Do not disturb" electronic doorbell
- › A total of two private car and driver transfers per voyage from/to the designated airport in the port city for embarkation and disembarkation or transfers to/from other locations within 100 miles of the port city for embarkation/disembarkation*

PENTHOUSE SUITE WITH BUTLER SERVICE 491 SQ. FT. (45.6 SQ. M.) WITH VERANDAH

- PS
- › Private verandah
- › Spacious living/dining area
- › Two ultra-thin 28" interactive HD TVs
- › Queen-size bed or twin beds with sumptuous bedding, and third berth
- › Full Jacuzzi bathtub with separate shower and bidet
- › Complimentary welcome bottle of champagne upon arrival
- › Walk-in closet
- › Binoculars
- › Free in-suite phone usage (One hour per cruise)
- › Free pressing service
- › Complimentary wine plus choice of spirits from set menu upon embarkation
- › Unlimited complimentary specialty restaurant dining (by reservation, based on space availability)
- › "Do not disturb" electronic doorbell

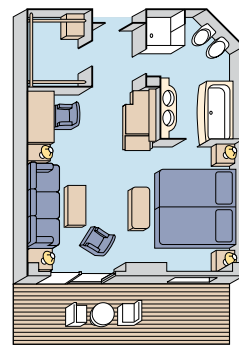

PENTHOUSE WITH BUTLER SERVICE 367 SQ. FT. (34 SQ. M.) WITH VERANDAH

- PH
- › Private verandah
- › Spacious living area
- › Ultra-thin 43" interactive HD TV
- › Queen-size bed or twin beds with sumptuous bedding, and third berth
- › Full Jacuzzi bathtub with separate shower
- › Complimentary welcome bottle of champagne upon arrival
- › Complimentary wine plus choice of spirits from set menu upon embarkation
- › Walk-in closet
- › Binoculars
- › Free pressing service
- › Unlimited complimentary specialty restaurant dining (by reservation, based on space availability)
- › "Do not disturb" electronic doorbell

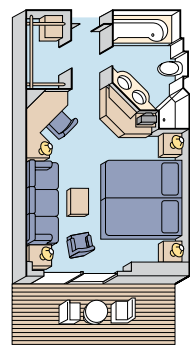

SEABREEZE PENTHOUSE SUITE WITH BUTLER SERVICE 491 SQ. FT. (45.6 SQ. M.) WITH VERANDAH

- SP
- › Private verandah
- › Spacious living area
- › King-size bed or twin beds with sumptuous bedding and third berth
- › Large luxury showers with body jets
- › Butler pass-through for deliveries
- › Walk-in closet
- › Two ultra-thin 43" interactive HD TVs
- › Complimentary welcome bottle of champagne upon arrival
- › Complimentary wine plus choice of spirits from set menu upon embarkation
- › Binoculars
- › Free pressing service
- › Washer/dryer combo
- › Unlimited complimentary specialty restaurant dining (by reservation, based on space availability)
- › "Do not disturb" electronic doorbell

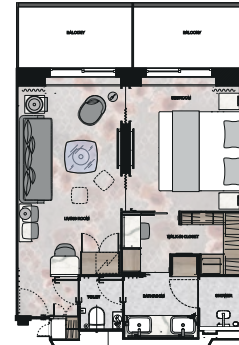

SEABREEZE PENTHOUSE WITH BUTLER SERVICE 367 SQ. FT. (34 SQ. M.) WITH VERANDAH

- SH
- › Private verandah
- › Spacious living area
- › Shared entryway to connect two Seabreeze Penthouses
- › King-size bed or twin beds with sumptuous bedding and third berth
- › Large luxury showers with body jets
- › Walk-in closet
- › Ultra-thin 43" interactive HD TV
- › Complimentary welcome bottle of champagne upon arrival
- › Complimentary wine plus choice of spirits from set menu upon embarkation
- › Binoculars
- › Free pressing service
- › Unlimited complimentary specialty restaurant dining (by reservation, based on space availability)
- › "Do not disturb" electronic doorbell

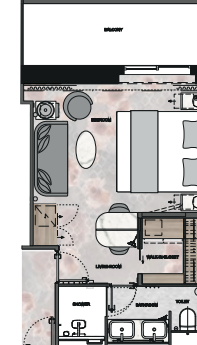

DELUXE STATEROOM WITH VERANDAH 246 SQ. FT. (23 SQ. M.) WITH VERANDAH

- A3 | ● A2 | ● A3
- B1 | ● B2
- › Categories A2 and A3: PURE staterooms feature a patented air purification system that creates a hypoallergenic environment. Visit CrystalCruises.com for details
- › Private verandah
- › Seating area
- › Queen-size bed or twin beds with sumptuous bedding
- › Ultra-thin 43" interactive HD TV
- › Full bathtub/shower combination
- › Spacious wall closet
- › Complimentary select beer, wine and spirits upon request
- A3 | B2:** Forward
- A2:** Slightly limited view

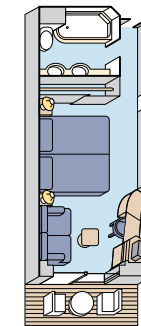

DELUXE STATEROOM WITH LARGE PICTURE WINDOW 202 SQ. FT. (18.7 SQ. M.)

- C1 | ● C2 | ● D
- E1 | ● E2
- › Large picture window
- › Seating area
- › Queen-size bed or twin beds with sumptuous bedding
- › Ultra-thin 42" interactive HD TV
- › Full bathtub/shower combination
- › Spacious wall closet
- › Complimentary select beer, wine and spirits upon request
- C2:** Forward
- E1:** Slightly limited view
- E2:** Extremely limited view

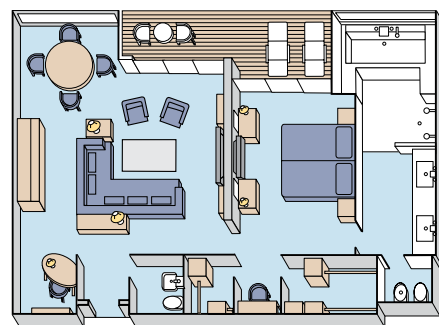
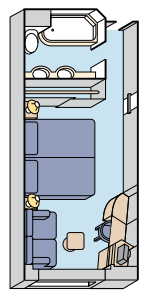

*Restrictions apply. Services are nontransferable. There are no credits given for forfeited services.
Please note: Penthouse and stateroom photos shown are examples of what is available and do not necessarily reflect all rooms or latest refurbishments, including but not limited to staterooms for guests with disabilities. Penthouses specially designed for guests with disabilities do not feature third berth.

ALL SUITES / STATEROOMS FEATURE

- COMPLIMENTARY UNLIMITED WI-FI
- REFRIGERATORS
- SECURITY SAFE
- COMPLIMENTARY SOFT DRINKS AND BOTTLED WATER IN ROOM
- HAIR DRYER
- SOPHISTICATED ONE-TOUCH LIGHTING SYSTEM
- ETRO BATHROBES, KIMONOS AND SLIPPERS